

QUICK START GUIDE



TS52 Power Harrow

IMPORTANT

READ

BEFORE

FIRST USE

QUICK START GUIDE

TS52 Power Harrow

ASSEMBLY TIPS

- The 3-point hitch frame does not install easily unless the components near it are loosened to create slack.
- First, remove the 8 bolts (#56) that secure the gearbox support frame.
- Loosen the 12 bolts (not shown in diagram) that secure the two supports (#4 and #5) to the frame cover (#1).
- Unscrew and remove the 6 bolts that secure the bracket (#7) to the supports (#4) and (#5).
- Insert the 3-point hitch frame (#3) in position, install and tighten all bolts and the installation is complete.

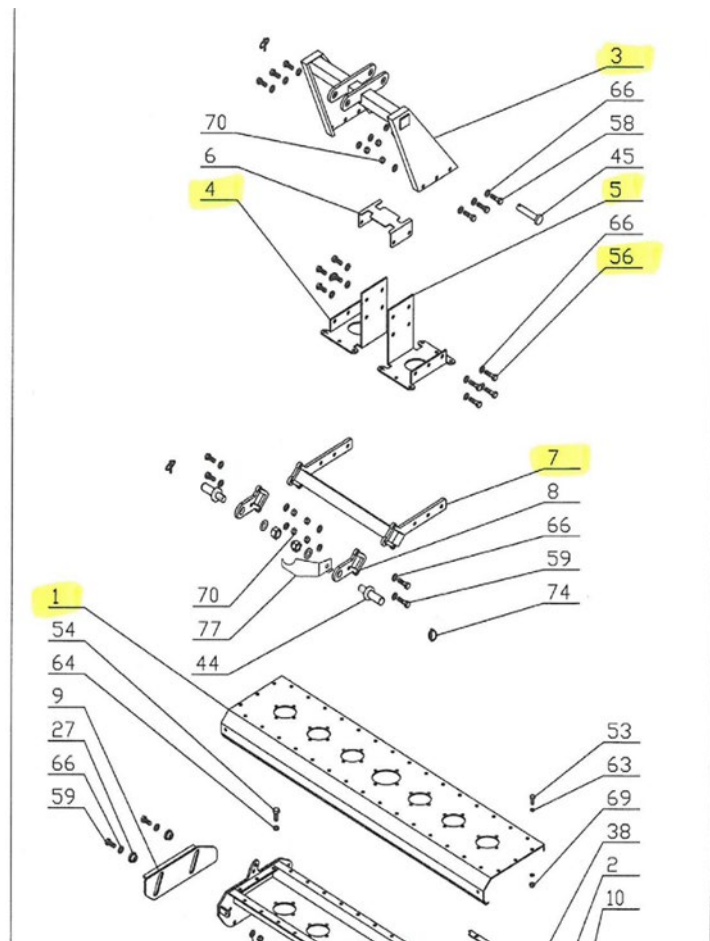

- **Note:** though it may appear that the leveling blade was not included with the machine, it is partially hidden if it ships installed in the rear position, behind the tines. The leveling blade can be detached and reinstalled in front if desired.
- As with any new implement, the shaft that attaches to the tractor may need to be cut to length. Consult the included Ibex Equipment PTO Shaft Cutting Guide.