

USE AND MAINTENANCE MANUAL

TRANSPORT BOX BEN 100/120/150



This manual is an integral part of the machine.

It must always accompany the machine and be kept within reach of the operator.

The enclosures mentioned are an integral part of this manual.

The purpose of this manual.

This manual gives information for the correct and safe use of the machine.

The owner must read this manual carefully before work with the machine.

Responsibility of the owner

The owner is responsible for accidents or damages caused to people or things due to negligence in following the instructions in this manual.

Assistance in using this manual

Explanations: contact the dealer.

Request for additional copies of the manual: in case of loss or wear and tear, or in case one wants the manual in a different language, the customer should ask the dealer or manufacturer.

Pay attention to the warning signals



<Danger>: indicates a situation that is potentially dangerous which, if not avoided, will cause death or serious damage.



<Warning>: indicates a situation that is potentially dangerous which, if not avoided, will cause death or serious damage.



<Caution>: indicates a situation that is potentially dangerous which, if not avoided, can cause minor to moderate damage, or it indicates to be careful about an unsafe procedure.

<Important> : indicates instructions that must be followed precisely in order to avoid damage to the product, process or environment.

<Note>: indicates supplementary information.

| |
|--------------------|
| DESCRIPTION |
|--------------------|

FUNCTION OF USE

The transport box BEN thanks to its lightness and hardness is specially suitable for all small jobs of transport inside factories, nurseries and erecting yards.

PERFORMANCES

Grazie al sistema di sgancio rapido è possibile ribaltare il pianale di carico con estrema facilità e stando seduti al posto di guida del trattore. Il sistema di aggancio automatico permette di riportare il pianale in posizione orizzontale semplicemente abbassando il sollevatore del trattore.

PERFORMANCES LIMIT

- ❑ Maximum capacity : BEN100 : 220 Lbs – BEN120 : 220 Lbs - BEN150 : 265 Lbs.
- ❑ Charges exceeding the maximum allowed can compromise the safety of the hook and the transport box functionality.

TECHNICAL SPECIFICATIONS

CHARACTERISTICS PER MODEL

| Model | Type | Width | | Depth | | Capacity | | III° point hitch | Weight | |
|------------|------|-------|------|-------|------|----------|-----|------------------|--------|-----|
| | | Cm | Inch | cm | Inch | Kg | Lbs | Cat. | kg | Lbs |
| BEN | 100 | 100 | 40 | 55 | 22 | 100 | 220 | 1 | 80 | 176 |
| BEN | 120 | 120 | 48 | 55 | 22 | 100 | 220 | 1 | 90 | 199 |
| BEN | 150 | 150 | 60 | 55 | 22 | 120 | 265 | 1 | 100 | 220 |

GENERAL REGULATIONS

- ❑ Only work in daylight.
- ❑ The machine must not be used near people, especially children or animals.
- ❑ Before to dump the transport box, be sure that, people, animals and things should be at safety distance.
- ❑ Wear long pants and heavy shoes.
- ❑ Pay attention using the transport box on slopes: proceed to the maximum slope and never work in slanting direction.
- ❑ Before leaving the driver's seat, turn off the engine of the tractor.
- ❑ Check immediately the transport box if it touches fixed objects.
- ❑ Change quickly defective parts.

SAFETY RESTRICTIONS

Children and people who are not familiar with these instructions must not be permitted to use the transport box. Local regulations can restrict the use of the transport box in accordance to the age.

TRANSPORT

Except when working, moving the machine takes place when the machine is standing still and the transmission is disconnected.

<Important>: keep speed low avoiding holes and ground roughness.

<Important>: Before begin the movements always make sure that the safety hooks be in position.

<Note when> on the road, obey existing traffic laws. Exhibit the signal signs on the rear ends. Respect any local laws there may be.

STORAGE

Store the machine in a dry place that isn't dusty.

INFORMATION ON DEMOLITION



At the end of its working life, the machine must be sent to be demolished and that can only be done by an authorized authority, in accordance with the national laws in force for the environment. Therefore it is necessary to get information from the qualified local authorities on the procedure to follow. The machine is mainly composed of : iron materials and paints.

WARRANTY

The machine is covered by the manufacturer warranty for a period of 24 months.

The warranty is not applicable when :

- a) The maintenance work has not been done correctly.
- b) The machine has been used out of its own service.
- c) The machine has been transformed or modified without the manufacturer's written authorization.

ASSEMBLING INSTRUCTION

- 1) Lay the level ground position 1 on two supports of a height of 1 meter.
- 2) Assemble the back panel position 3 on the level ground 1 using 5 bolts position 8+9+10+11.
- 3) Assemble the right side panel position 4 fixing it to the level ground and to the back panel through 8 bolts position 8+9+10+11.
- 4) Repeat the operation 4 assembling the left side panel position 5.
- 5) For a correct alignment of all components of the transport-box it is necessary to proceed to the final locking of the bolt kit after the assembling of all components.
- 6) Insert in its housing created in the front part of the side panels the door position 6 locking it through n° 4 spring pins position 22.
- 7) Assemble the third point position 2 on arms position 7 using bolts position 23+24+25.
- 8) Insert in the housings created in the lower part of the level round, the hitch brackets position 2+7, then insert in the holes, the screws position 14 and lock all these components using the washers position 12 and the nuts position 13.
- 9) Insert in its holes the pins position 15 and lock them with the split pins position 16.
- 10) Fix the chain position 21 on the hitch position 7 through the bolt position 17+18+19.
- 11) Fix the second end of the chain position 21 to the welded hitch to the back panel position 3 the bolt position 20+18+19.

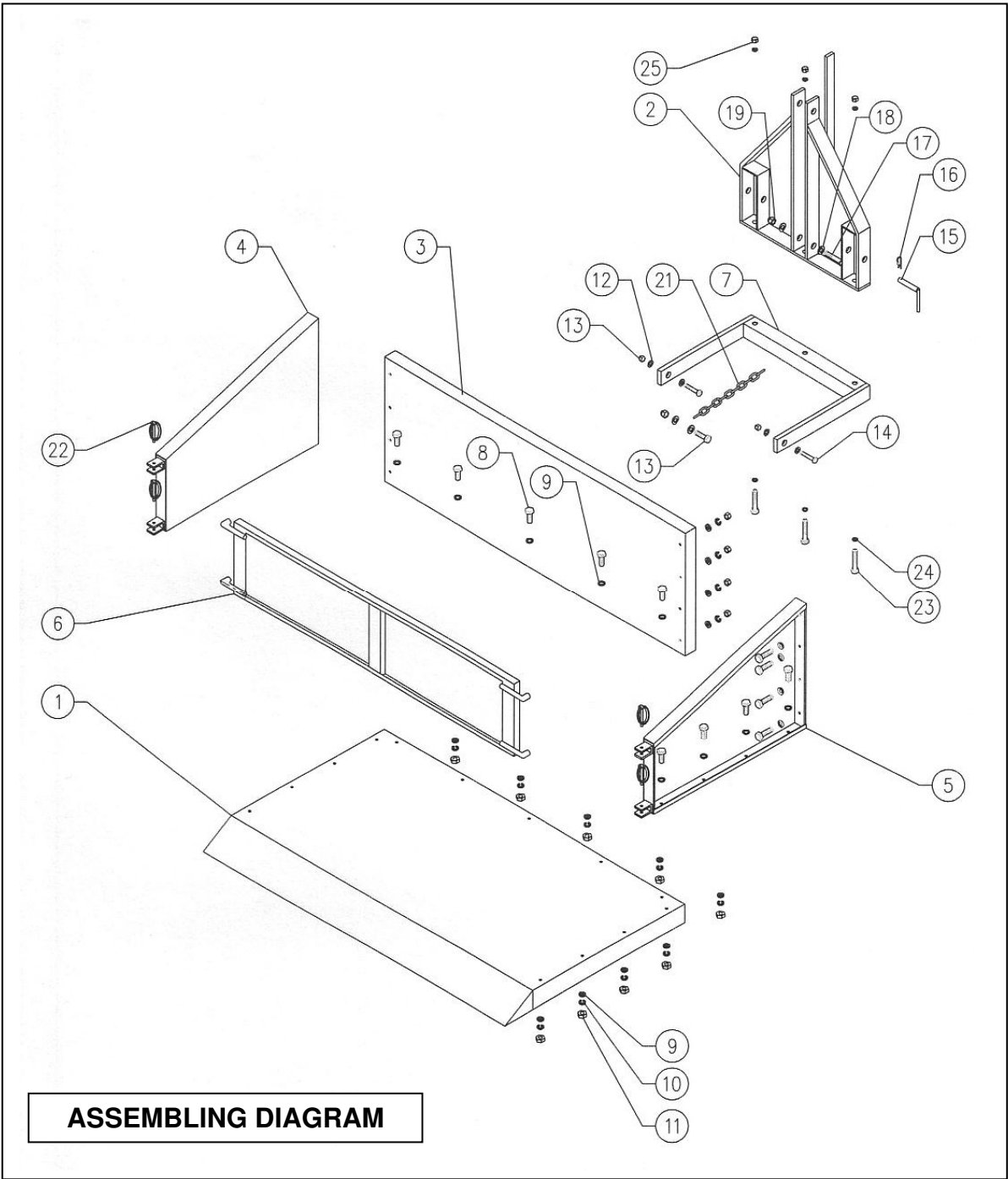

SPARE PARTS BEN 100

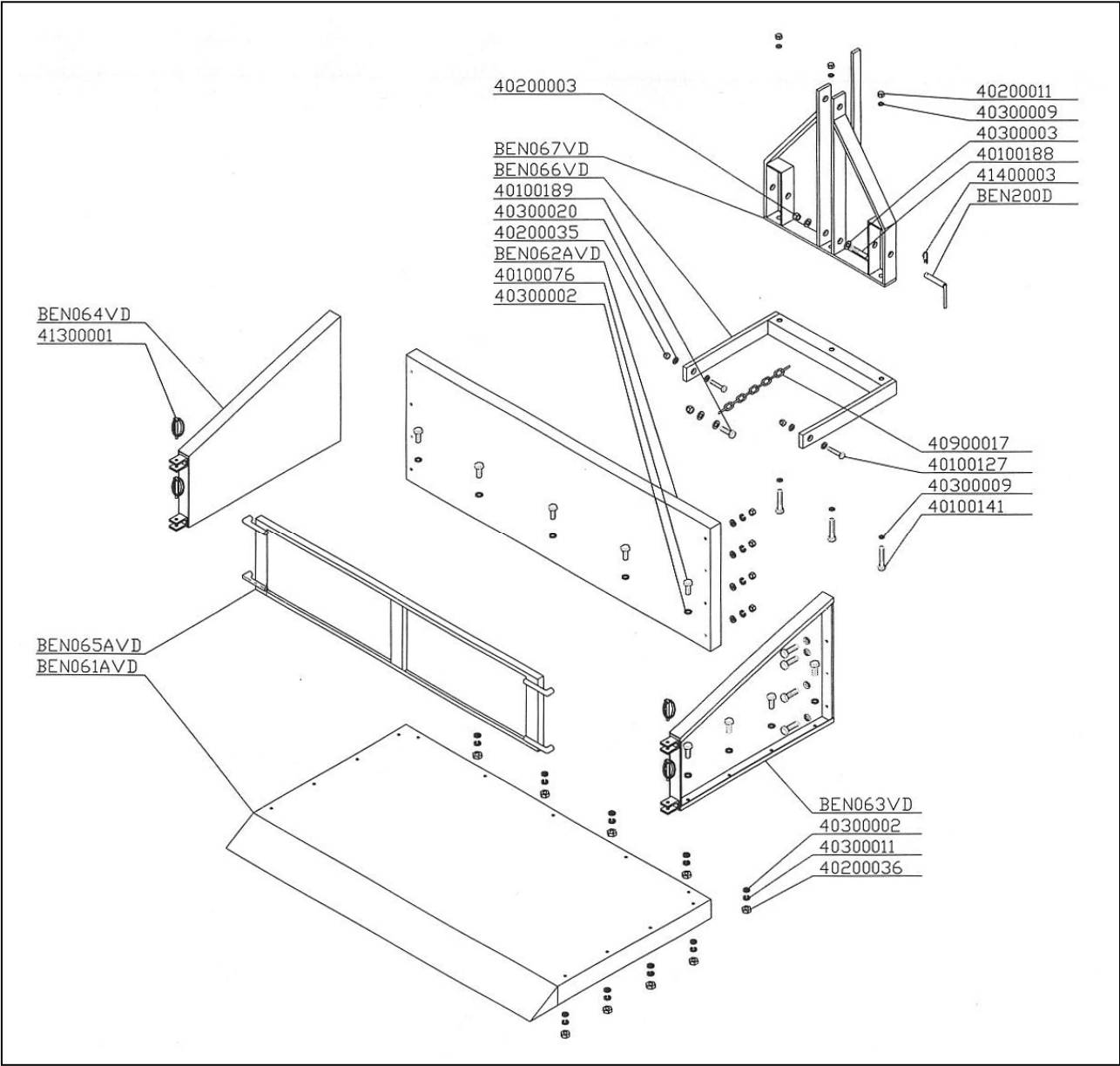

SPARE PARTS BEN 120

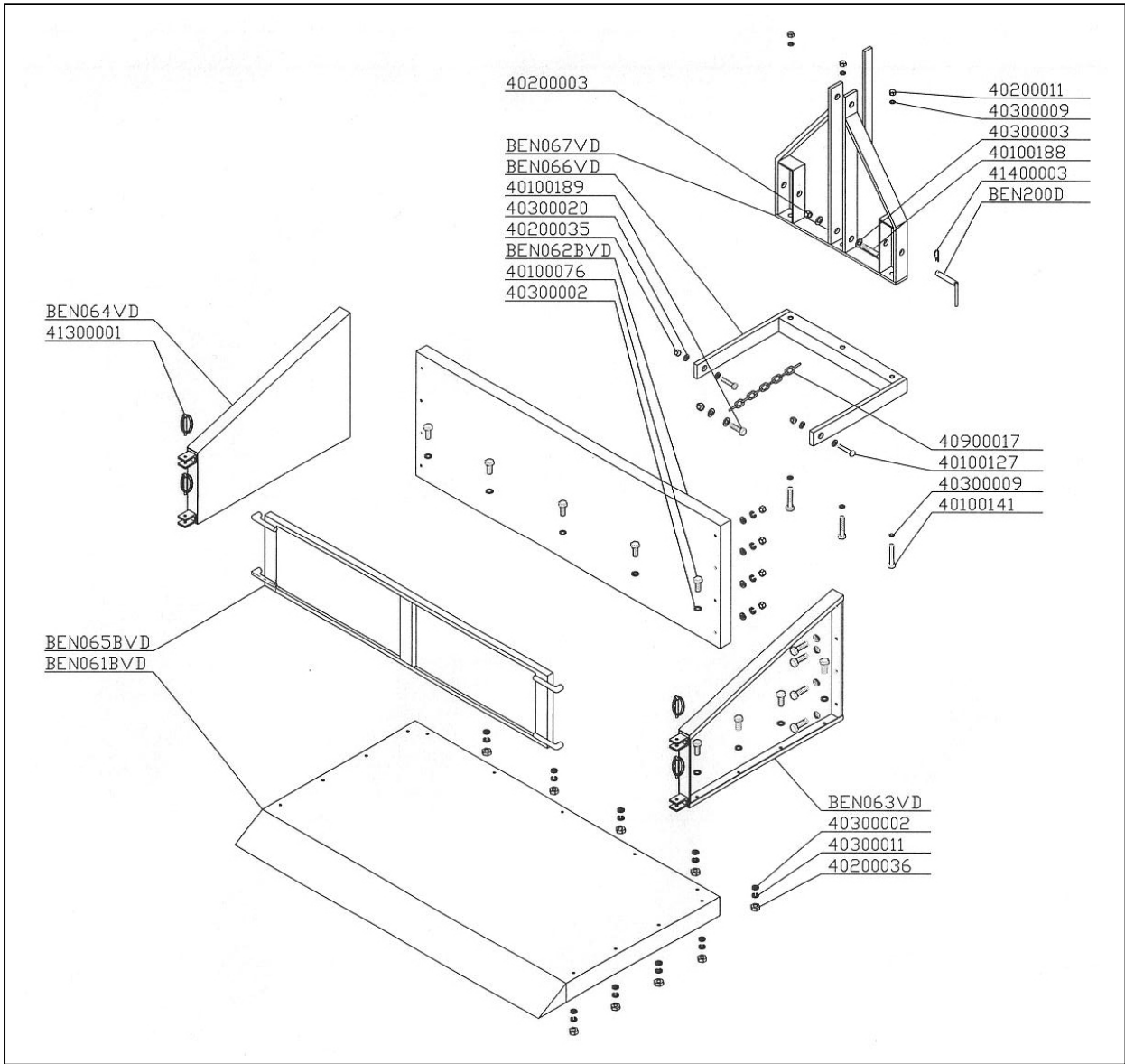

SPARE PARTS BEN 150

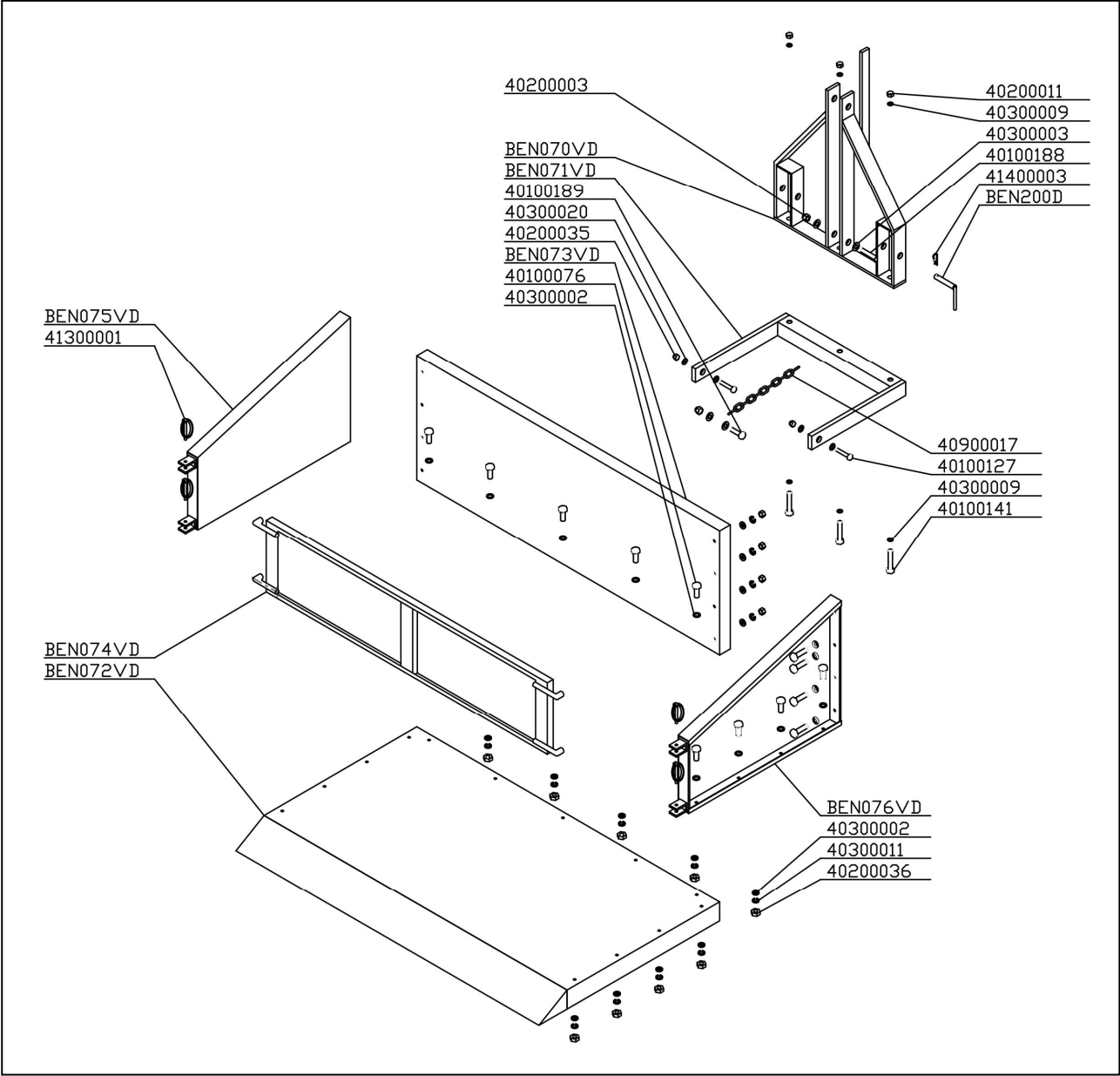

INDEX

| | |
|---------------------------------------|-----------|
| PREFACE | 2 |
| DESCRIPTION | 3 |
| FUNCTION OF USE | 3 |
| PERFORMANCES..... | 3 |
| PERFORMANCES LIMIT..... | 3 |
| TECHNICAL SPECIFICATIONS..... | 4 |
| SAFETY INFORMATION | 5 |
| GENERAL REGULATIONS..... | 5 |
| SAFETY RESTRICTIONS | 5 |
| TRANSPORT | 6 |
| STORAGE | 6 |
| INFORMATION ON DEMOLITION..... | 6 |
| WARRANTY | 6 |
| ASSEMBLING INSTRUCTION | 7 |
| SPARE PARTS BEN 100..... | 9 |
| SPARE PARTS BEN 120..... | 10 |
| SPARE PARTS BEN 150..... | 11 |